

APPENDIX A

Modular Unit Floor Plan

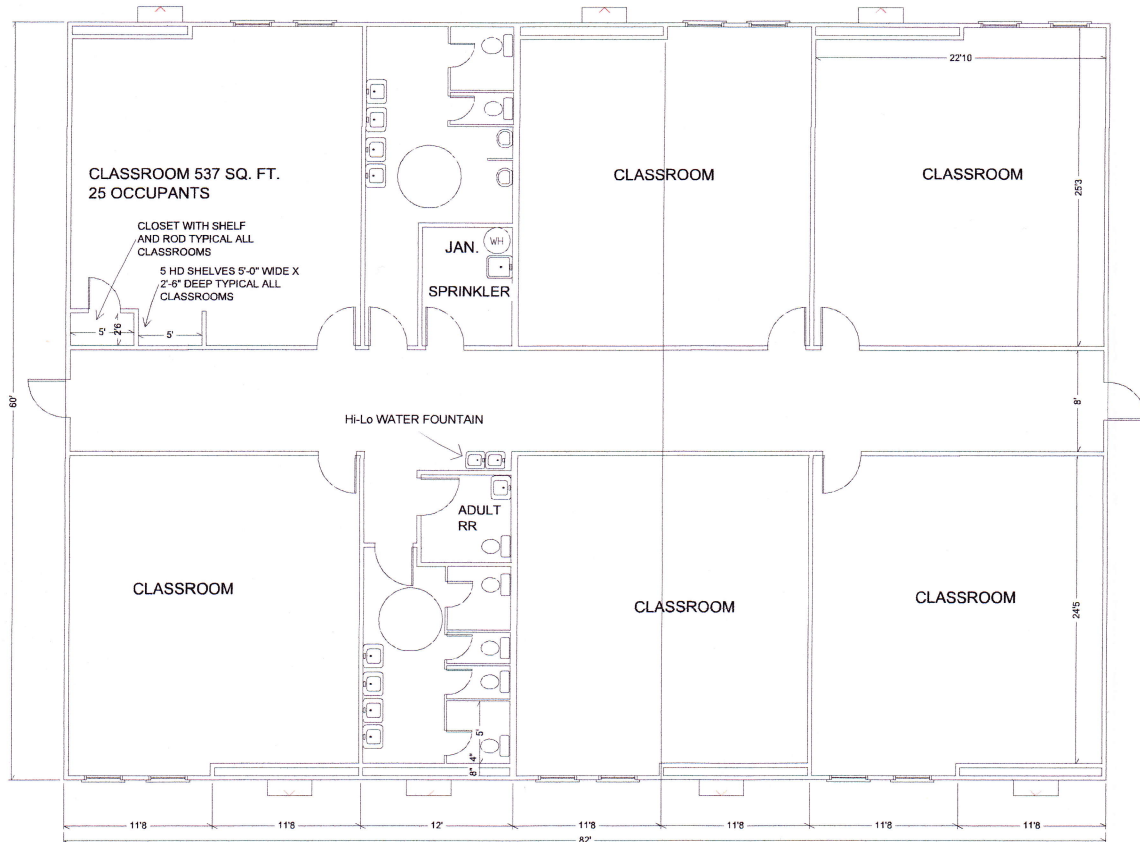

Gerry Kenworthy
 3 Great Valley Pkwy. Ste. 170
 Malvern, PA 19355
 (610) 232-2923
 gkenworthy@vanguardmodular.com
 www.vanguardmodular.com

Proposed Classroom Building

This drawing and the information herein has been provided to you by a Vanguard Modular Building Systems Representative. This document shall be held confidential. Reuse or reproduction in whole or part is prohibited.

Drawing Date:
04/04/13

Drawn By:
Vanguard

Scale:
NTS

Project:
Proposal

Drawing:
Sketch 2